

- Install on upper rail with dished washer # A-1H21
- Washer to be located central to wear strip holes/slots.
- Provide a 3/8" gap between strips (at ambient temp 60-80 deg)
- Weld to steel rail or using countersunk concrete screws(floor)
- Use countersunk machine screws # A-1H21-1-SET. (return rails)

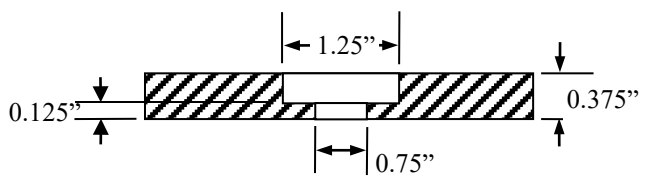
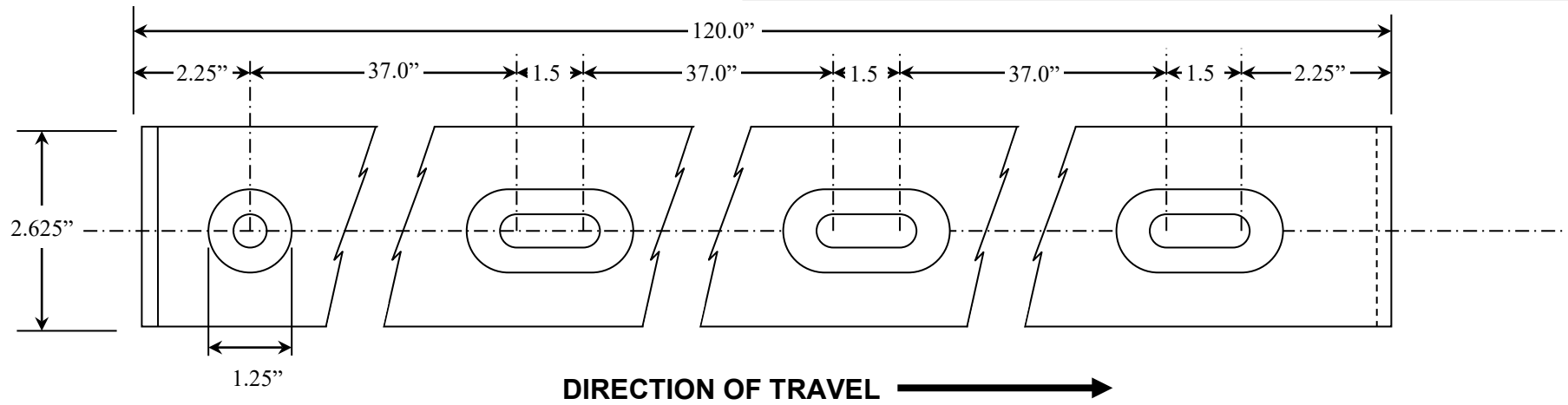

Hole Section View

Material: UHMW-PE
 45 degree bevel at ends (up one side/down one side)
 Counter bore per section view

Assembly Item # 103
 Refer to Drawing for assembly location

Drawing Item # 103

Drawn Staff	
Approved Engineering	
NOT TO SCALE	WEAR STRIP, 3-inch
	Part # 4-1511-1.25